

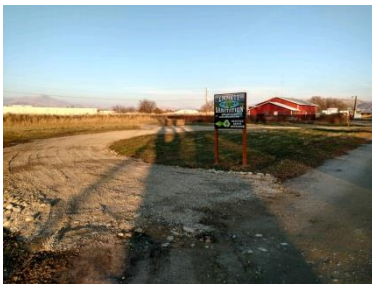

Emmett Sanitation Recycle Depot
2200 S Boise Ave
Emmett, ID 83617

- The recycle depot sits on the front portion of Emmett Sanitation's property, to the east side of our gated facility. You enter the depot loop to the left - just off South Boise Avenue. The depot is open to residents of both Gem County and the City of Emmett. **Please do not enter the fenced operations yard area.**



- Emmett Sanitation limits the material accepted to **Cardboard, Aluminum Beer/Soda Cans, and Plastic Containers (#'s 1 & 2 only)**. We may expand the program in the future depending on overall participation and the ability to find sustainable markets for the material.

- The depot is open **Monday - Friday from 8am - 5pm**. As we monitor the depot's usage over time, we may modify those hours in case of emergency and depending on overall activity.

- Please keep the recycle depot open and free to the public by observing the guidelines.

- Please **break down cardboard** and rinse plastic drinking, detergent and milk jugs prior to dropping them off in the appropriate bins. Your cooperation is greatly appreciated.

- **IF THE BINS ARE FULL, DO NOT DUMP YOUR MATERIAL.** Allow Emmett Sanitation an opportunity to empty the containers first, you are welcome to make another attempt when the bins have adequate space.

- **PLEASE, NO trash, furniture, electronics waste, paint cans, motor oil, batteries, household hazardous waste or other illegal dumping allowed.** The recycle depot is monitored 24 hours a day by surveillance camera.



- Customer Care -
208.365.6103

www.idwaste.com